

**STREET  
LIGHTING**



**STREET  
LIGHTS**



**STREETLED 60 - SPRESIANO**

**CUSTOMIZED LIGHT SOLUTION - PORTO CERVO**



**STREETLED 24 - BANGKOK**



# streetled 60



INSTALLAZIONE INSTALLATION NOTES

# 7000

PRODOTTO / PRODUCT

STREET LIGHTS

LEDS No.: 60



7000

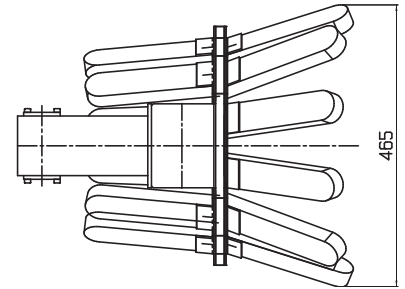
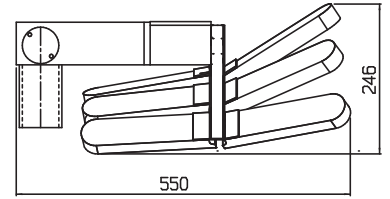

OTTICA / LENS



Fissaggio su palo diametro 60mm  
Fixing pole diameter 60mm



IP 65

| CODICE DIMMER<br>DIMMER CODE | COLORE LED<br>LED COLOUR | ALIMENTAZIONE<br>POWER SUPPLY | mA  | Watt | Lm   | Note       |
|------------------------------|--------------------------|-------------------------------|-----|------|------|------------|
| <b>00</b> - no dimmer        | <b>01</b> - 6500°K       | <b>01</b> - 24 VDC            | 350 | 69   | 6420 | <b>DIM</b> |
| <b>01</b> - dimmer           | <b>02</b> - 5000°K       | <b>02</b> - 24 VDC            | 450 | 102  | 8474 | <b>DIM</b> |
|                              | <b>03</b> - 4000°K       | <b>11</b> - 230 VAC           | 350 | 69   | 6420 |            |
|                              | <b>04</b> - 3500°K       | <b>12</b> - 230 VAC           | 450 | 102  | 8474 |            |

ESEMPIO COMPOSIZIONE CODICE  
CODE COMPOSITION EXAMPLE

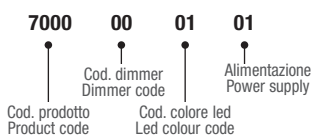

# streetled 68

# 7002

PRODOTTO / PRODUCT

STREET LIGHTS

LEDS No.: 68



7002

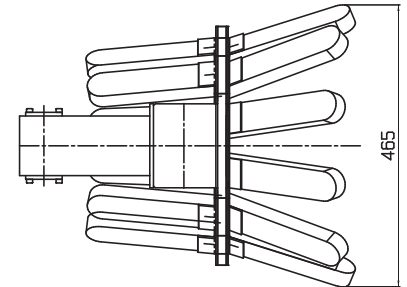
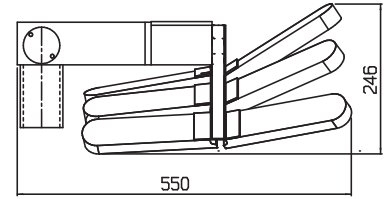

OTTICA / LENS



Fissaggio su palo diametro 60mm  
Fixing pole diameter 60mm



**IP 65**

| CODICE DIMMER<br>DIMMER CODE | COLORE LED<br>LED COLOUR | ALIMENTAZIONE<br>POWER SUPPLY | mA  | Watt | Lm   | Note       |
|------------------------------|--------------------------|-------------------------------|-----|------|------|------------|
| <b>00</b> - no dimmer        | <b>01</b> - 6500°K       | <b>02</b> - 24 VDC            | 450 | 99   | 8560 | <b>DIM</b> |
| <b>01</b> - dimmer           | <b>02</b> - 5000°K       | <b>12</b> - 230 VAC           | 450 | 99   | 8560 |            |
|                              | <b>03</b> - 4000°K       |                               |     |      |      |            |
|                              | <b>04</b> - 3500°K       |                               |     |      |      |            |

ESEMPIO COMPOSIZIONE CODICE  
CODE COMPOSITION EXAMPLE

**7002**   **00**   **01**   **01**  
 Cod. prodotto   Cod. dimmer   Cod. colore led   Alimentazione  
 Product code   Dimmer code   Led colour code   Power supply





# streetled 68 cutoff



INSTALLAZIONE INSTALLATION NOTES

# 7006

PRODOTTO / PRODUCT

7006

STREET LIGHTS

LEDS No.: 68

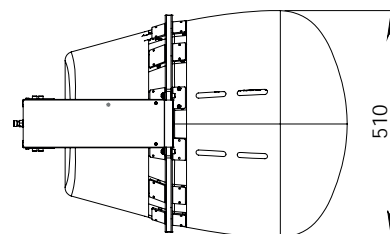
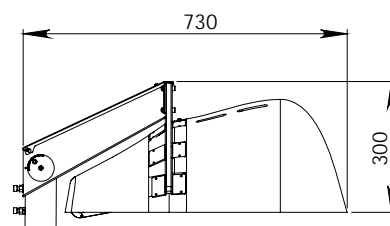

OTTICA / LENS



Fissaggio su palo diametro 60mm  
Fixing pole diameter 60mm



**IP 65**

| CODICE DIMMER<br>DIMMER CODE | COLORE LED<br>LED COLOUR | ALIMENTAZIONE<br>POWER SUPPLY | mA  | Watt | Lm   | Note       |
|------------------------------|--------------------------|-------------------------------|-----|------|------|------------|
| 00 - no dimmer               | 01 - 6500°K              | 02 - 24 VDC                   | 450 | 99   | 8560 | <b>DIM</b> |
| 01 - dimmer                  | 02 - 5000°K              | 12 - 230 VAC                  | 450 | 99   | 8560 |            |
|                              | 03 - 4000°K              |                               |     |      |      |            |
|                              | 04 - 3500°K              |                               |     |      |      |            |

ESEMPIO COMPOSIZIONE CODICE  
CODE COMPOSITION EXAMPLE

**7006**   **00**   **01**   **01**  
 Cod. prodotto   Cod. dimmer   Cod. colore led   Alimentazione  
 Product code   Dimmer code   Led colour code   Power supply



# streetled 68 xpg cutoff



INSTALLAZIONE INSTALLATION NOTES

# 7007

PRODOTTO / PRODUCT

7007

STREET LIGHTS

LEDS No.: 68

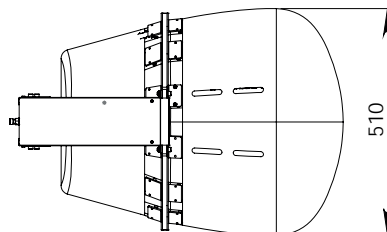
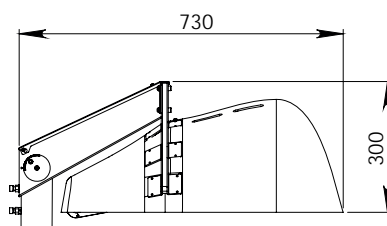



OTTICA / LENS



Fissaggio su palo diametro 60mm  
Fixing pole diameter 60mm



 **IP 65**

| CODICE DIMMER<br>DIMMER CODE | COLORE LED<br>LED COLOUR | ALIMENTAZIONE<br>POWER SUPPLY | mA  | Watt | Lm    | Note   |
|------------------------------|--------------------------|-------------------------------|-----|------|-------|--|
| 00 - no dimmer               | 01 - 6500°K              | 02 - 24 VDC                   | 450 | 99   | 14000 |  <b>DIM</b> |
| 01 - dimmer                  | 02 - 5000°K              | 12 - 230 VAC                  | 450 | 99   | 14000 |             |
|                              | 03 - 4000°K              |                               |     |      |       |  |
|                              | 04 - 3500°K              |                               |     |      |       |  |

ESEMPIO COMPOSIZIONE CODICE  
CODE COMPOSITION EXAMPLE

**7007**   **00**   **01**   **01**  
 |   |   |   |  
 Cod. prodotto   Cod. dimmer   Cod. colore led   Alimentazione  
 Product code   Dimmer code   Led colour code   Power supply



**STREET  
LIGHTS**



**STREETLED 60 CUTOFF - BELLUNO**

**STREETLED 32 - ALTAVILLA (RFI)**



**PEDXING 30 - PARMA**

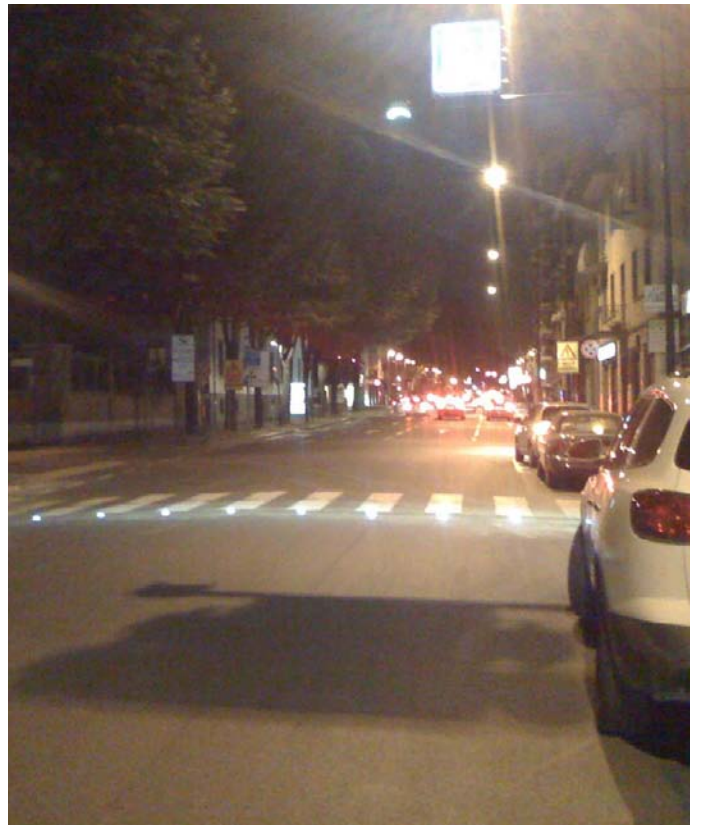

# streetled 24



INSTALLAZIONE INSTALLATION NOTES

# 7012

PRODOTTO / PRODUCT

7012

STREET LIGHTS

LEDS No.: 24

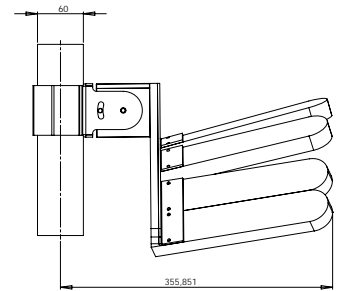
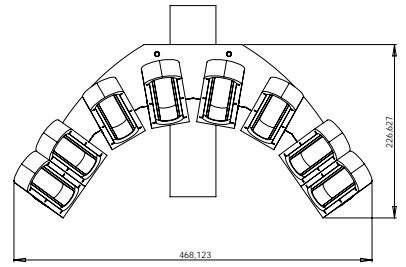

Fissaggio su palo diametro 60mm  
Fixing pole diameter 60mm

OTTICA / LENS



RoHS COMPLIANT



IP 65

| CODICE DIMMER<br>DIMMER CODE | COLORE LED<br>LED COLOUR | ALIMENTAZIONE<br>POWER SUPPLY | mA  | Watt | Lm   | Note  |
|------------------------------|--------------------------|-------------------------------|-----|------|------|-------|
| 00 - no dimmer               | 01 - 6500°K              | 01 - 24 VDC                   | 350 | 29   | 2568 | ⚡ DIM |
| 01 - dimmer                  | 02 - 5000°K              | 02 - 24 VDC                   | 450 | 43   | 3390 | ⚡ DIM |
|                              | 03 - 4000°K              | 11 - 230 VAC                  | 350 | 29   | 2568 | ⚡     |
|                              | 04 - 3500°K              | 12 - 230 VAC                  | 450 | 43   | 3390 | ⚡     |

ESEMPIO COMPOSIZIONE CODICE  
CODE COMPOSITION EXAMPLE

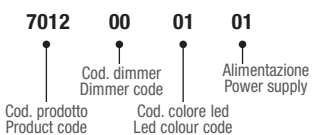

# streetled 32



INSTALLAZIONE INSTALLATION NOTES

# 7009

PRODOTTO / PRODUCT

7009

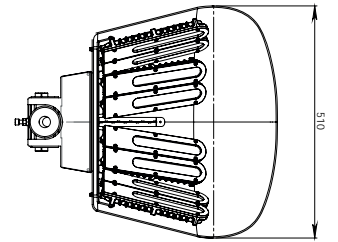

STREET LIGHTS

LEDS No.: 24

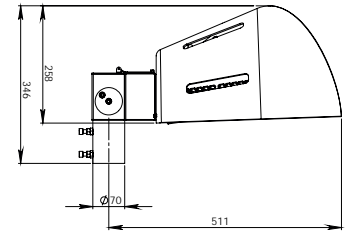

Fissaggio su palo diametro 60mm  
Fixing pole diameter 60mm

OTTICA / LENS



IP 65

| CODICE DIMMER<br>DIMMER CODE | COLORE LED<br>LED COLOUR | ALIMENTAZIONE<br>POWER SUPPLY | mA  | Watt | Lm   | Note  |
|------------------------------|--------------------------|-------------------------------|-----|------|------|-------|
| 00 - no dimmer               | 01 - 6500°K              | 01 - 24 VDC                   | 350 | 40   | 3424 | ⚡ DIM |
| 01 - dimmer                  | 02 - 5000°K              | 02 - 24 VDC                   | 450 | 59   | 4519 | ⚡ DIM |
|                              | 03 - 4000°K              | 11 - 230 VAC                  | 350 | 40   | 3424 | ⚡     |
|                              | 04 - 3500°K              | 12 - 230 VAC                  | 450 | 59   | 4519 | ⚡     |

ESEMPIO COMPOSIZIONE CODICE  
CODE COMPOSITION EXAMPLE

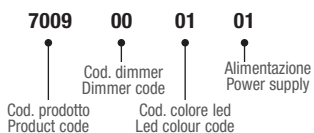

# pedxing 30



INSTALLAZIONE INSTALLATION NOTES

# 7200

PRODOTTO / PRODUCT

STREET LIGHTS

LEDS No.: 30

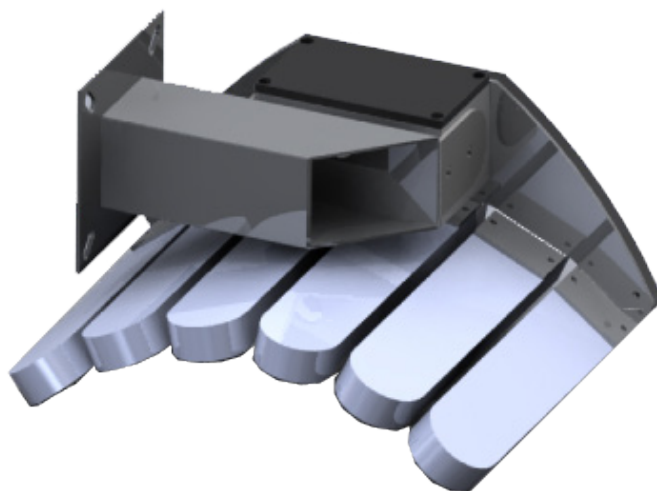

OTTICA / LENS

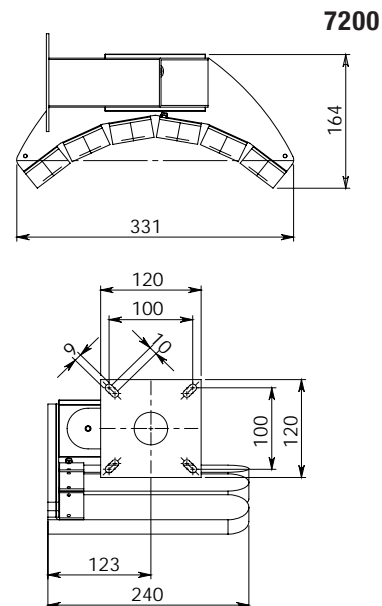

Flangia di fissaggio 120x120mm  
Fixing flange 120x120mm



**IP 65**

| CODICE DIMMER<br>DIMMER CODE | COLORE LED<br>LED COLOUR | ALIMENTAZIONE<br>POWER SUPPLY | mA  | Watt | Lm   | Note       |
|------------------------------|--------------------------|-------------------------------|-----|------|------|------------|
| <b>00</b> - no dimmer        | <b>01</b> - 6500°K       | <b>01</b> - 24 VDC            | 350 | 35   | 3210 | <b>DIM</b> |
| <b>01</b> - dimmer           | <b>02</b> - 5000°K       | <b>02</b> - 24 VDC            | 450 | 52   | 4237 | <b>DIM</b> |
|                              | <b>03</b> - 4000°K       | <b>11</b> - 230 VAC           | 350 | 35   | 3210 |            |
|                              | <b>04</b> - 3500°K       | <b>12</b> - 230 VAC           | 450 | 52   | 4237 |            |

ESEMPIO COMPOSIZIONE CODICE  
CODE COMPOSITION EXAMPLE

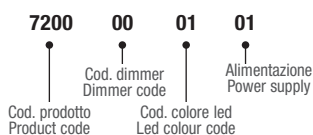

# tunnel 36

# 7100

PRODOTTO / PRODUCT

7100

STREET LIGHTS

LEDS No.: 36

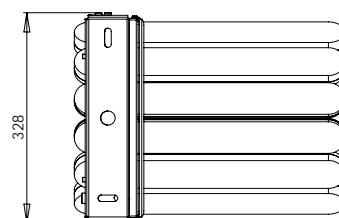
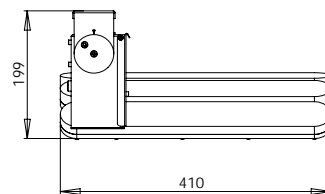

OTTICA / LENS



**IP 65**

| CODICE DIMMER<br>DIMMER CODE | COLORE LED<br>LED COLOUR | ALIMENTAZIONE<br>POWER SUPPLY | mA  | Watt | Lm   | Note       |
|------------------------------|--------------------------|-------------------------------|-----|------|------|------------|
| <b>00</b> - no dimmer        | <b>01</b> - 6500°K       | <b>01</b> - 24 VDC            | 350 | 42   | 3852 | <b>DIM</b> |
| <b>01</b> - dimmer           | <b>02</b> - 5000°K       | <b>02</b> - 24 VDC            | 450 | 62   | 5071 | <b>DIM</b> |
|                              | <b>03</b> - 4000°K       | <b>11</b> - 230 VAC           | 350 | 42   | 3852 |            |
|                              | <b>04</b> - 3500°K       | <b>12</b> - 230 VAC           | 450 | 62   | 5071 |            |

ESEMPIO COMPOSIZIONE CODICE  
CODE COMPOSITION EXAMPLE

